



ШКИВЫ ЗУБЧАТЫЕ SYNCHROCHAIN ДЛЯ КОНИЧЕСКИХ ВТУЛОК ТАПЕРБУШ

14M

Шаг 14 mm

Для ремней шириной 37 mm

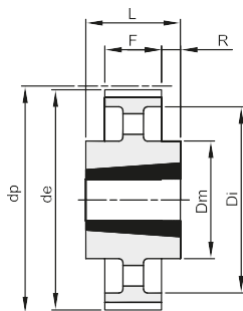

14

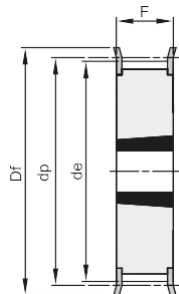

15 F

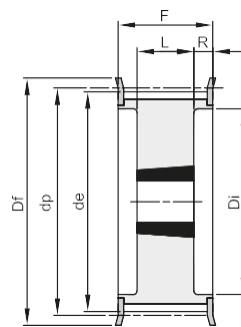

18 F

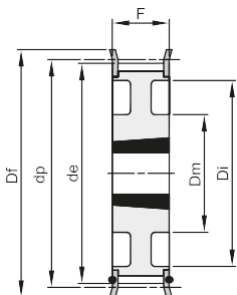

21 F

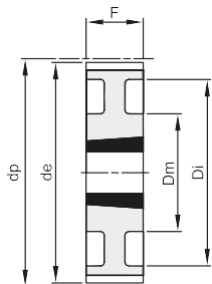

21

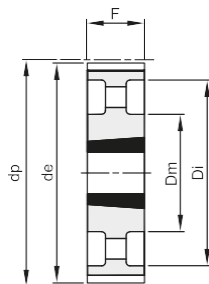

22

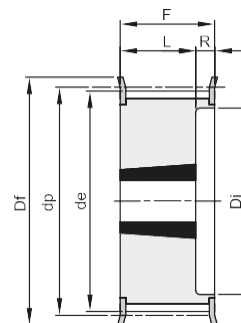

23 F

Материал: Сталь (St)
Материал: Чугун (GG)

| Описание | Артикул | Тип | Материал | Число зубьев | Макс Втулка | Макс отверстие | dp | de | Df | Dm | Di | F | L | R | n° фланец | Вес, kg |
|----------------|----------------|-----|----------|--------------|-------------|----------------|--------|--------|-----|-----|-----|----|----|------|-----------|---------|
| TL 14M 28S 37 | PCB48037028EMT | 23F | St | 28 | 2012 | 50 | 124,78 | 121,98 | 127 | | 88 | 51 | 32 | 19 | 400 | 2,20 |
| TL 14M 30S 37 | PCB48037030EMT | 18F | St | 30 | 2517 | 65 | 133,69 | 130,89 | 138 | | 98 | 51 | 45 | 3 | 401 | 2,50 |
| TL 14M 32S 37 | PCB48037032EMT | 18F | St | 32 | 2517 | 65 | 142,60 | 139,80 | 154 | | 100 | 51 | 45 | 3 | 403 | 3,00 |
| TL 14M 34S 37 | PCB48037034EMT | 18F | St | 34 | 2517 | 65 | 151,52 | 148,72 | 160 | | 109 | 51 | 45 | 3 | 404 | 3,80 |
| TL 14M 36S 37 | PCB48037036EMT | 23F | St | 36 | 2517 | 65 | 160,43 | 157,63 | 168 | | 117 | 51 | 45 | 6 | 405 | 4,30 |
| TL 14M 38S 37 | PCB48037038EMT | 23F | St | 38 | 2517 | 65 | 169,34 | 166,54 | 183 | | 126 | 51 | 45 | 6 | 406 | 5,10 |
| TL 14M 40S 37 | PCB48037040EMT | 23F | St | 40 | 2517 | 65 | 178,25 | 175,45 | 188 | | 135 | 51 | 45 | 6 | 407 | 6,00 |
| TL 14M 44S 37 | PCB48037044EMT | 15F | St | 44 | 3020 | 75 | 196,08 | 193,28 | 211 | | | 51 | | | 411 | 7,00 |
| TL 14M 48S 37 | PCB48037048EMT | 15F | St | 48 | 3020 | 75 | 213,90 | 211,11 | 226 | | | 51 | | | 412 | 9,00 |
| TL 14M 50S 37 | PCB48037050EMT | 15F | GG | 50 | 3020 | 75 | 222,82 | 220,02 | 240 | | | 51 | | | 414 | 10,00 |
| TL 14M 56S 37 | PCB48037056EMT | 21F | GG | 56 | 3020 | 75 | 249,55 | 246,76 | 256 | 144 | 207 | 51 | | | 416 | 9,20 |
| TL 14M 60S 37 | PCB48037060EMT | 21 | GG | 60 | 3020 | 75 | 267,38 | 264,58 | | 159 | 224 | 51 | | | | 10,20 |
| TL 14M 64S 37 | PCB48037064EMT | 21 | GG | 64 | 3020 | 75 | 285,21 | 282,41 | | 159 | 242 | 51 | | | | 12,20 |
| TL 14M 72S 37 | PCB48037072EMT | 21 | GG | 72 | 3020 | 75 | 320,86 | 318,06 | | 159 | 278 | 51 | | | | 13,40 |
| TL 14M 80S 37 | PCB48037080EMT | 21 | GG | 80 | 3020 | 75 | 356,51 | 353,71 | | 159 | 314 | 51 | | | | 16,10 |
| TL 14M 90S 37 | PCB48037090EMT | 22 | GG | 90 | 3020 | 75 | 401,07 | 398,27 | | 159 | 360 | 51 | | | | 17,20 |
| TL 14M 112S 37 | PCB48037112EMT | 22 | GG | 112 | 3020 | 75 | 499,11 | 496,31 | | 159 | 456 | 51 | | | | 23,30 |
| TL 14M 140S 37 | PCB48037140EMT | 14 | GG | 140 | 3525 | 90 | 623,89 | 621,09 | | 206 | 581 | 51 | 65 | 7 | | 41,00 |
| TL 14M 168S 37 | PCB48037168EMT | 14 | GG | 168 | 3525 | 90 | 748,66 | 745,87 | | 206 | 706 | 51 | 65 | 7 | | 51,50 |
| TL 14M 192S 37 | PCB48037192EMT | 14 | GG | 192 | 4030 | 90 | 855,61 | 852,82 | | 215 | 812 | 51 | 76 | 12,5 | | 60,00 |